



UNDERCOUNTER
ICE MACHINE

WU-0100-AC

AIR COOLED

KEY FEATURES:

- Stainless-steel exterior (durable & rust-resistant)
- Up to 105 lbs of ice production (70F/50F, 24H)
- Ice type: full cube
- 27 lbs of ice storage
- Control board diagnostics
- Improved freezing surface technology
- Easy access to the front air filter
- Stainless steel legs for height adjustment
- Air ventilation (front air in and out)
- Easy exchange front load **built-in** water filter
- R-134A refrigerant
- Power cord with NEMA 5-15 plug
- Energy Star® qualified 

STANDARD WARRANTY:

- Ice Maker: 3-Year Parts & Labor
- Evaporator: 5-Year Parts & Labor
- Compressor: 5-Year Parts & 3-Year Labor



FWU-0100R

*Built in Carbon Block Water Filter
(One unit is included when you buy a new machine)*



Remove air filter by sliding forward



Front, in/out ventilation for optimal air flow and efficient production



**Easy replacement
Water Filter**

A filter is required for this machine to operate. If your machine stops producing ice, it is likely time to replace this filter. It is recommended that you replace the filter every 6 months, or more often depending on the quality of your water.

CERTIFICATIONS



WU-0100-AC

UNDERCOUNTER ICE MACHINE

PLAN VIEW

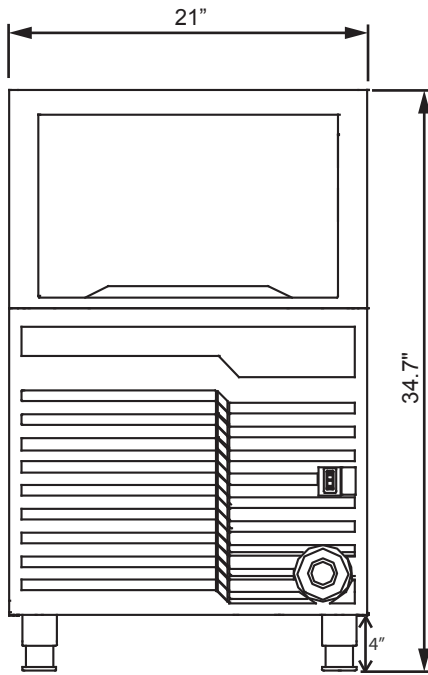

FRONT VIEW

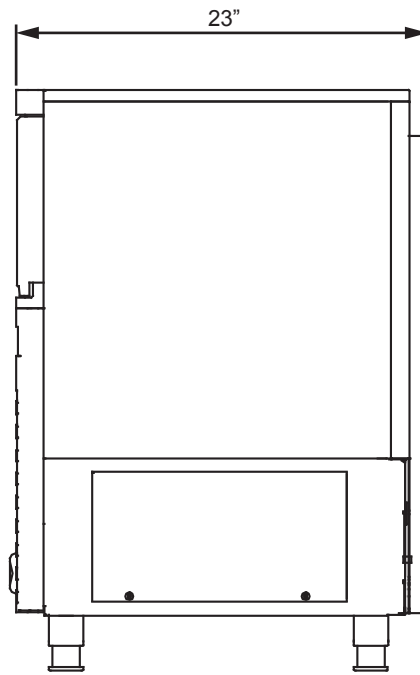

SIDE VIEW

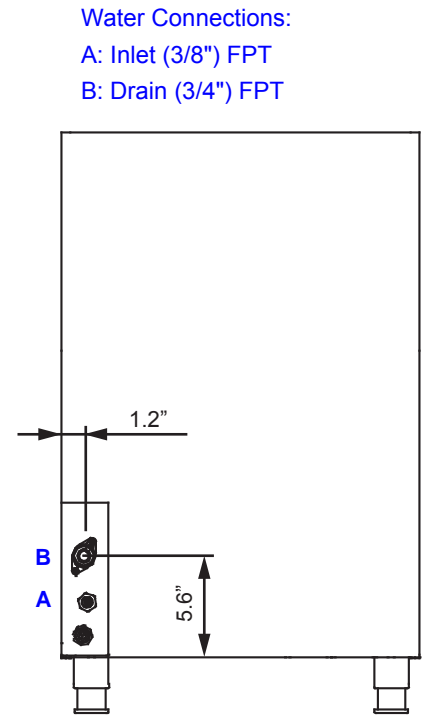

BACK VIEW

Water Connections:

A: Inlet (3/8") FPT

B: Drain (3/4") FPT

MODEL	DIMENSIONS	WIDTH	DEPTH	HEIGHT	WEIGHT
WU-0100-AC	Inch	21"	23"	34.7"	112 lbs (Net)

SPECIFICATIONS								
Model	Ice Shape	Ice Production per 24 hrs		Water usage Gal / 100 lbs ice	Power kWh / 100 lbs ice	Electrical (V/Hz/ph)	Condenser	Minimum Circuit Breaker (A)
		70 °F Air/ 50 °F Water	90 °F Air/ 70 °F Water					
WU-0100-AC	Cube	105 lbs	74 lbs	19	9.39	115 / 60 / 1	Air Cooled	15

OPERATING LIMITS	MIN	MAX
AMBIENT TEMP RANGE	50 °F	100 °F
WATER TEMP RANGE	50 °F	90 °F
WATER PRESSURE	20 psi (1.38 bar)	80 psi (5.52 bar)



ICE SHAPE (CUBE)

7/8" X 7/8" X 7/8"



* Design and specifications are subject to change without prior notice.